

INSTRUCTION MANUAL

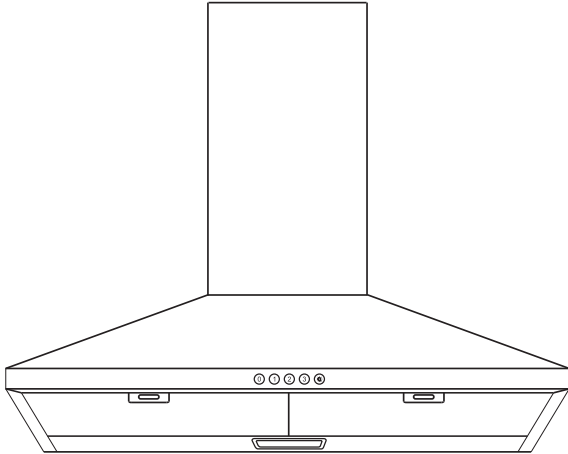

JX-D0630

AC 120V 60Hz

**PLEASE READ INSTRUCTIONS CAREFULLY BEFORE ASSEMBLY
RETAIN THIS MANUAL FOR FUTURE REFERENCE**

CONTENT

Introduction	2
Safety Precaution	2
Parts Diagram	3-4
Installation Instructions	5-6
Air Outlet Installation Method	6
Installation	7-8
Filter Installation	9
Operation	9
Maintenance	10-11
Trouble-Shooting	12
Environmental Protection	12

Introduction

Thank you for choosing this cooker hood.

- This instruction manual is designed to provide you with all required instructions related to the installation, use and maintenance of the appliance.
- In order to operate the unit correctly and safely, please read this instruction manual carefully before installation and usage.

Safety Precaution

- Never let the children operate the machine.
- The cooker hood is for home use only, not suitable for barbecue, roast shop and other commercial purpose.
- Clean the cooker hood according to the instruction manual and keep the unit from danger of burning. There is a fire risk if cleaning is not carried out in accordance with the instructions.
- Please keep the kitchen room a good convection before connecting this appliance; Please check that the power supply cord is undamaged. A damaged supply cord must be replaced by qualified service personnel only.
- Regulations concerning the discharge of air have to be fulfilled.
- This appliance can be used by children aged from 8 years and above also the persons with reduced physical, sensory or mental capabilities or lack of experience and knowledge if they have been given supervision or instruction concerning use of the appliance in a safe way and understand the hazards involved. Children shall not play with the appliance. Cleaning and user maintenance shall not be made by children without supervision.
- If the supply cord is damaged, it must be replaced by the manufacturer, its service agent or similarly qualified persons in order to avoid a hazard.



CAUTION:

Accessible parts may become hot when used with cooking appliance.

Electrical Shock Hazard

Only plug this unit into a properly earthed outlet.

If you have doubts, seek advice from a suitably qualified engineer.

Parts Diagram

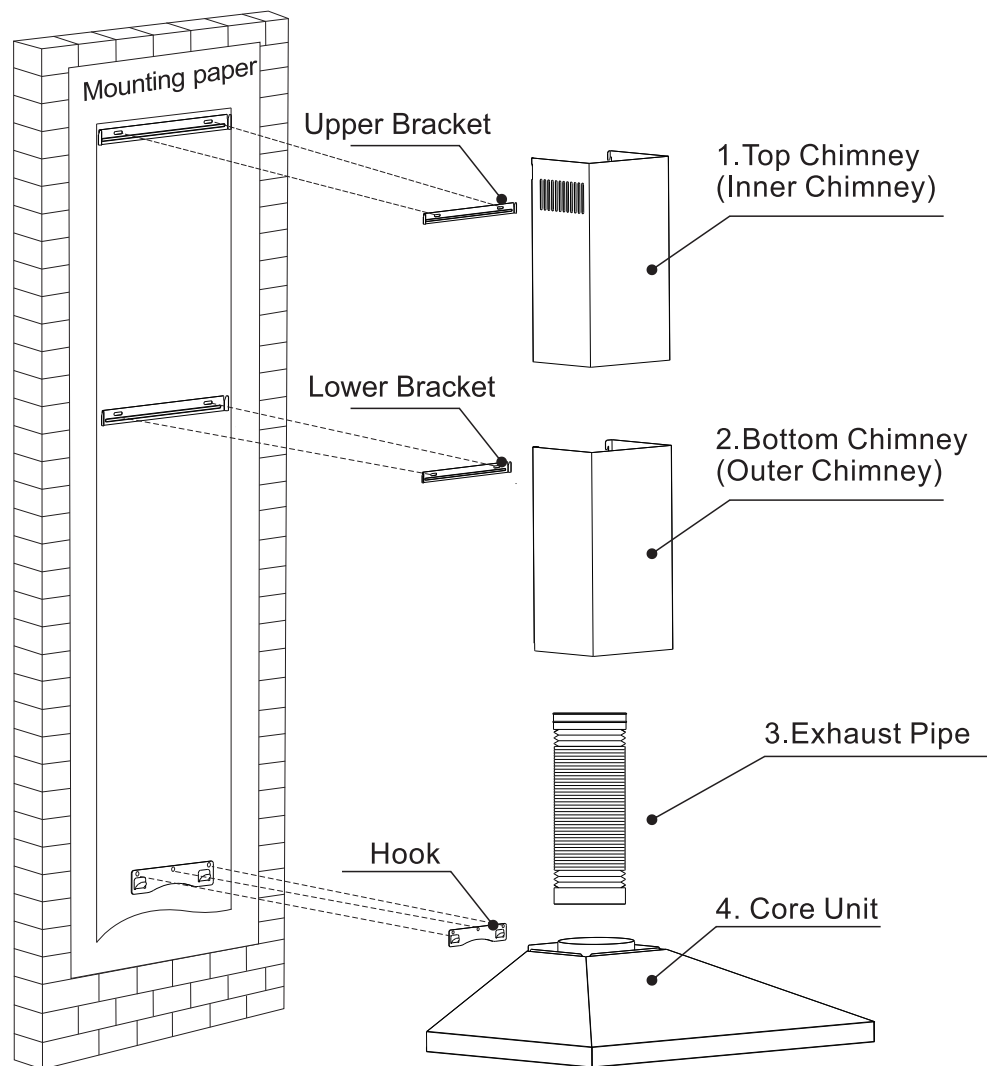

Parts Supplied

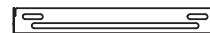

Upper Chimney Bracket

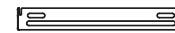

Lower Chimney Bracket

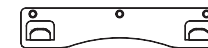

Range Hood Hook

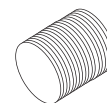

Flexible Pipe

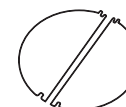

Dampers



$\times 11$
St4 $\times 30$



$\times 11$
 $\phi 5 \times \phi 8$



$\times 4$
St3 $\times 10$

Tools Required



Pencil

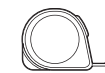

Measuring tape

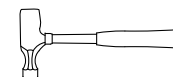

Hammer

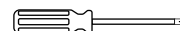

Screwdriver



Level



Electric drill



Duct Tape



Gloves

Installation Instructions

Prepare for installation:

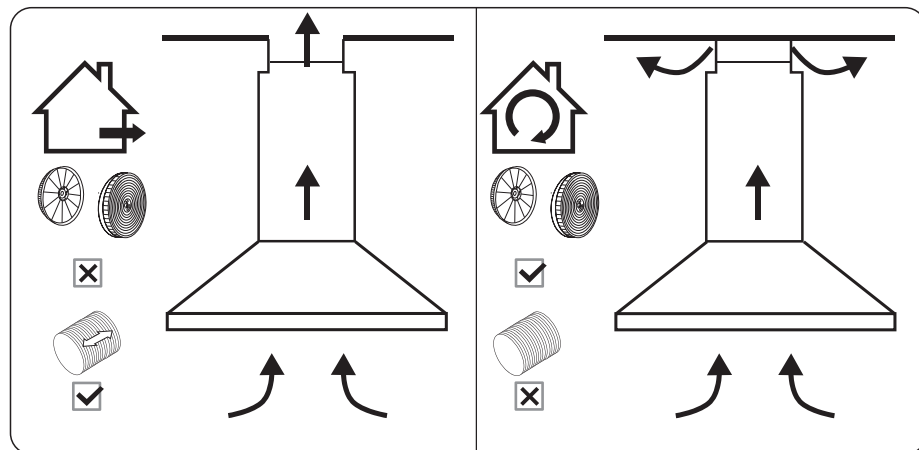

DUCTED OPTION

RECIRCULATION OPTION

a. If you have an outlet to the outside, your cooker hood can be connected as above picture by means of a pipe (with an interior diameter of 150mm). If you don't have an outlet to the outside, you can go with recirculation mode by using charcoal filters.

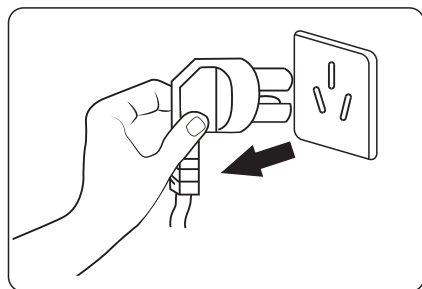

b. Before installation, turn the unit off and unplug it from the outlet.

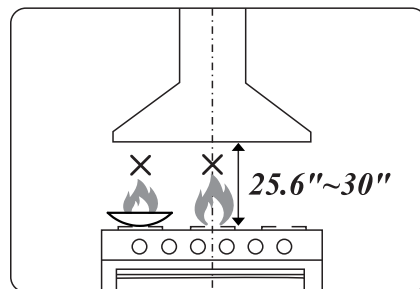

c. The cooker hood should be placed at a distance of 25.6"~30" above the cooktop for the best effect.

Note: The charcoal filters are not provided, please buy individually if need.



No open flames directly approach to the range hood.

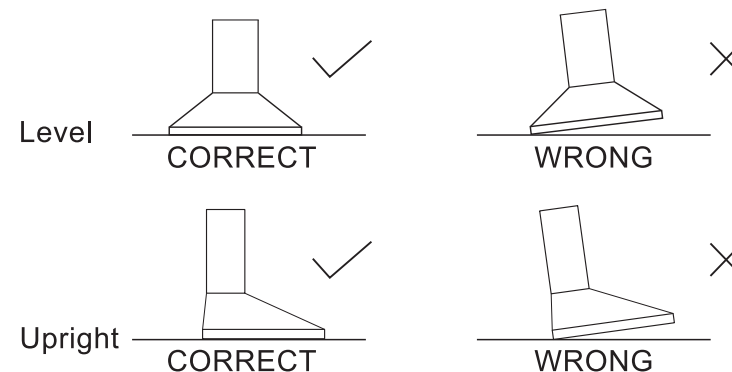

After hanging the unit on the wall, ensure the range hood is straight and horizontal.

Air Outlet Installation Method

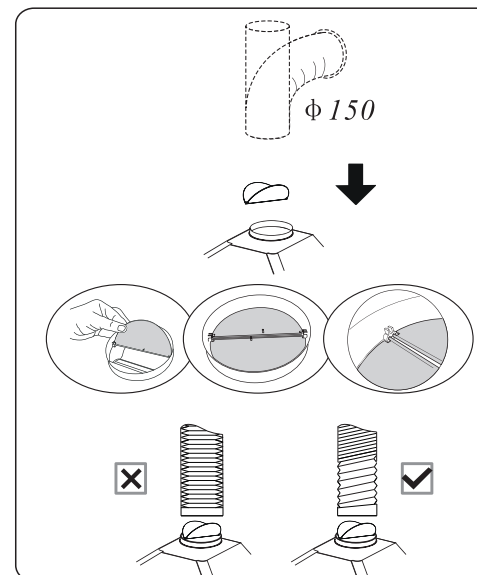

Installation method for 150mm diameter pipe: insert the one-way-value as the pic and fix the duct.

Attention: The bump of the one-way-value must be upward.

The pipe near the air outlet need to be fully extended.

Installation

Note Please connect the power supply to test and confirm that the power is on before installing this wall mount range hood.

Refer to the installation instructions:

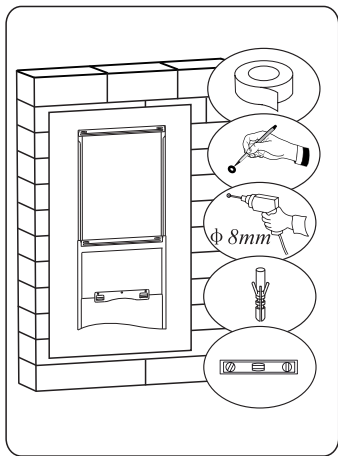

Prepare pencil, electric drill, plastic wall anchors and level before installation.
Recommended installation height: 27.6"
Required minimum installation height: 25.6"

1. Stick the installation template on the wall.
2. Drill the holes which showing on the template.

CAUTION:

Peel off the paper after drilling the holes.
The chimney covers height can be adjusted from 500mm to 750mm.

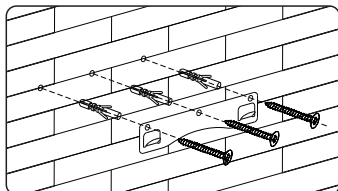

Drill 3 x 8mm holes to accommodate the bracket. Screw and tighten the hook onto the wall with the screws & plastic wall anchors provided.

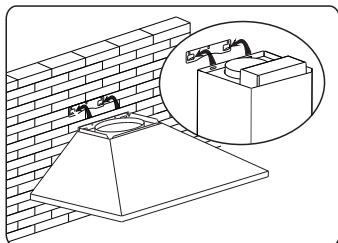

Lift the cooker hood and hang onto the wall hook.

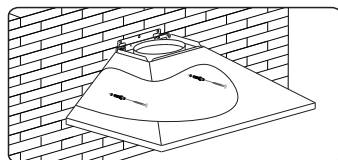

Need to drill 2x8mm extra holes & fixing screws & plastic wall anchors before installation.

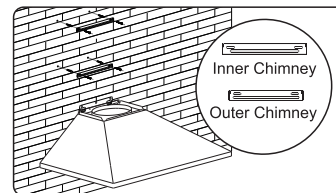

Mark the position and drill 2 holes for each chimney bracket and tighten the bracket with screws.

Note The longer bracket is upper chimney bracket

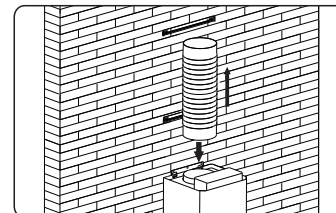

Fix the one-way-value to the air outlet of the cooker hood, and then attached the pipe onto the air outlet as picture.

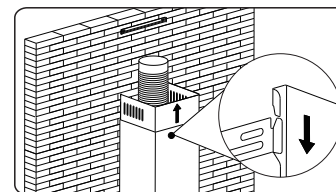

Put the upper chimney into lower chimney . Then pulling out the upper chimney upwards. Adjust to reach the height required.

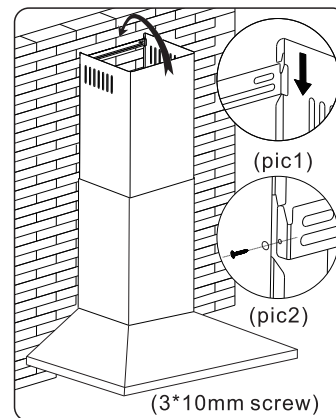

There are 2 methods for installing the chimney cover. Please check the below pic for reference.

1. After drilling the 2 holes and fixing the bracket, hang the chimney cover by matching the both side lock. (Pic1)

2. After drilling the 2 holes and fixing the bracket, install the chimney cover by locking with 2 screws in both side holes. (Pic2)

CAUTION:

BEFORE USE

Please remove the white/blue protective film on the rangehood, chimney covers and baffle filters.

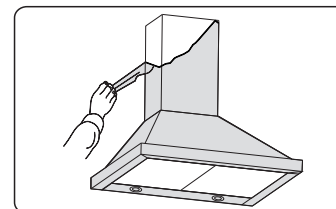

Filter Installation

Aluminium Filter:

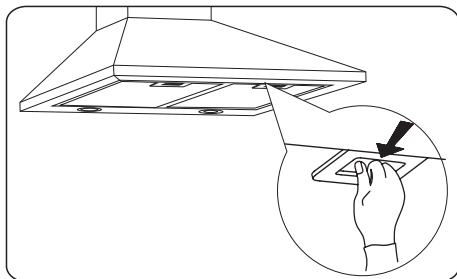

Operation

Push Button



- ① **OFF Button**
Turn off the fan.
- ① **Low Speed Button**
Starts the fan at low speed .
- ② **Medium Speed Button**
Starts the fan at medium speed.
- ③ **High Speed Button**
Starts the fan at high speed.
- ☀ **Light Button**
Used for turning on/off the light.

Maintenance

Before cleaning switch the unit off and pull out the plug.

I. Regular Cleaning

Use a soft cloth moistened with hand-warm mildly soapy water or household cleaning detergent. Never use metal pads, chemical, abrasive material or stiff brush to clean the unit.

II. LED Light Replacement

Switch the unit off and unplug the appliance.

CAUTION: LAMP UNIT MAY BE HOT!

WAIT UNTIL THE UNIT IS COOL. *BEFORE attempting to replace the LED lamps make sure the unit is powered off and UNPLUGGED.*

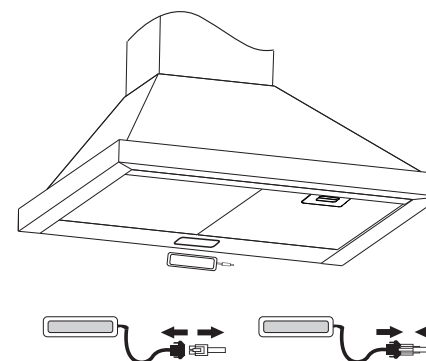

III. Filter filters replacement

In order to install the carbon filter, the grease filter should be detached first. Press the lock and pull it downward.

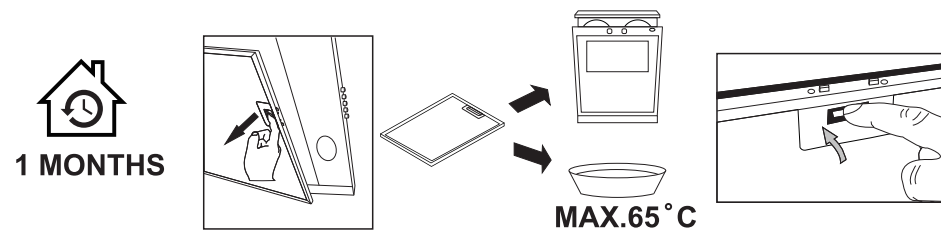

Filters: To avoid fires, clean thoroughly once a month or whenever the display pilot lights up (if fitted). To do so, remove the filters and soak in hot water and detergent for an hour. If using a dishwasher, position the filters vertically to improve the cleaning process.

Important Notice:

1. Make sure the filter is securely locked. Otherwise, it would loosen and cause abnormal noise and danger.
2. Using charcoal filter would reduce the air flow of the range hood.

Trouble-Shooting

Fault	Cause	Solution
Light on, but fan does not work	The fan blade is jammed.	Switch off the unit and repair by qualified service personnel only.
	The motor is damaged.	
Both light and fan do not work	Light is burnt out.	Replace the LED light with correct rating.
	Power cord is loose.	Plug into the power supply again.
Serious Vibration of the unit	The fan blade is damaged.	Switch off the unit and repair by qualified service personnel only.
	The fan motor is not fixed tightly.	
	The unit is not hung properly on the bracket.	Take down the unit and check whether the bracket is in proper location.
Suction performance not good	Too far distance between the unit and the cooktop.	Readjust the distance between 25.6"-30"

Environmental Protection

Waste electrical products should not be disposed of with household waste. Please recycle where facilities exist. Check with your Local Authority or retailer for recycling advice.

